

**Features**

- Zero reverse recovery
- Zero forward recovery
- Temperature independent switching behavior
- Positive temperature coefficient on  $V_F$
- Very low stray inductance
- Low noise switching
- RoHS compliant

**Applications**

- Welding equipment
- Uninterruptible power supply (UPS)
- High frequency power supply
- Induction heating
- High speed rectifiers

**Maximum Ratings**

Parameter	Symbol	Rating	Unit
Peak Repetitive Reverse Voltage@ $T_j=25^\circ\text{C}$	$V_{RRM}$	1200	V
DC Blocking Voltage@ $T_j=25^\circ\text{C}$	$V_{DC}$	1200	V
Continuous forward Current	@ $T_C=25^\circ\text{C}$	60	A
	@ $T_C=125^\circ\text{C}$	30	
	@ $T_C=135^\circ\text{C}$	25	
Non-repetitive Peak Forward Surge Current @ $T_C=25^\circ\text{C}$ , $t_p=10\text{ms}$ , Half Sine Pulse	$I_{FSM}$	215	A
$I^2t$ Value, $T_C=25^\circ\text{C}$ , $T_P=10\text{ms}$	$\int i^2 dt$	230	$\text{A}^2\text{S}$
Power Dissipation@ $T_C=25^\circ\text{C}$	$P_D$	155	W

**Circuit Diagram**



**1200V  
SiC Diode  
Power Module**

**VDC 1200V**  
**I<sub>F</sub> 2x30A**

FJ

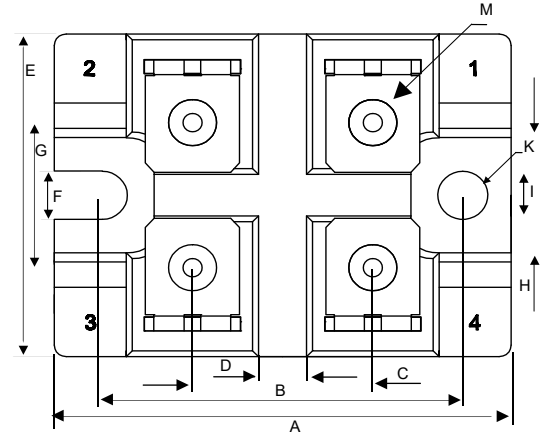
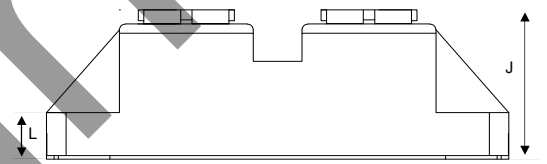

DIM	INCHES		MM		NOTE
	MIN	MAX	MIN	MAX	
A	1.484	1.508	37.50	38.50	
B	1.169	1.193	29.50	30.50	
C	0.579	0.602	14.50	15.50	
D	0.146	0.169	3.50	4.50	
E	1.091	1.114	27.50	28.50	
F	0.154	0.177	3.70	4.70	
G	0.484	0.508	12.10	13.10	
H	0.382	0.406	9.50	10.50	
I	0.130	0.154	3.10	4.10	
J	0.492	0.516	12.30	13.30	
K	0.165		4.20		∅
L	0.146	0.169	3.50	4.50	
M	0.157		4.00		

**Electrical Characteristics @ 25°C (Unless Otherwise Specified)**

Parameter	Symbol	Conditions	Typ.	Max.	Units
Forward Voltage	$V_F$	$I_F=30A, T_J=25^\circ C$	1.36	1.7	V
		$I_F=30A, T_J=175^\circ C$	1.72		V
Reverse Leakage Current	$I_R$	$V_R=1200V, T_J=25^\circ C$	1.4	100	$\mu A$
		$V_R=1200V, T_J=175^\circ C$	4.13		$\mu A$
Total Capacitive Charge	$Q_C$	$V_R=800V$	168		nC
Total capacitance	C	$V_R=1V, f=1MHz$	1820		pF
		$V_R=400V, f=1MHz$	158		pF
		$V_R=800V, f=1MHz$	118		pF
Capacitance Stored Energy	$E_C$	$V_R=800V$	44		$\mu J$

**● Module Characteristics**

**TC=25° C unless otherwise specified**

Parameter	Symbol	Conditions	Value			Unit
			Min.	Typ.	Max.	
Thermal Resistance Junction-to-Heatsink	$R_{thjc}$	Per Leg		0.94		K/W
Operating junction and Storage Temperature	$T_j$		-40		175	°C
Storage Temperature	$T_{stg}$		-40		125	°C
Mounting torque	$T_M$	To Sink Recommended (M4)	1.0		1.5	Nm
Mounting torque	$T_M$	To Terminal Recommended (M4)	1.0		1.5	Nm
Weight of Module	W			32		g
Isolation Voltage	$V_{isol}$	AC,50HZ(R.M.S),t=3s	3600			V

## Curve Characteristics

Fig1. Forward Characteristics

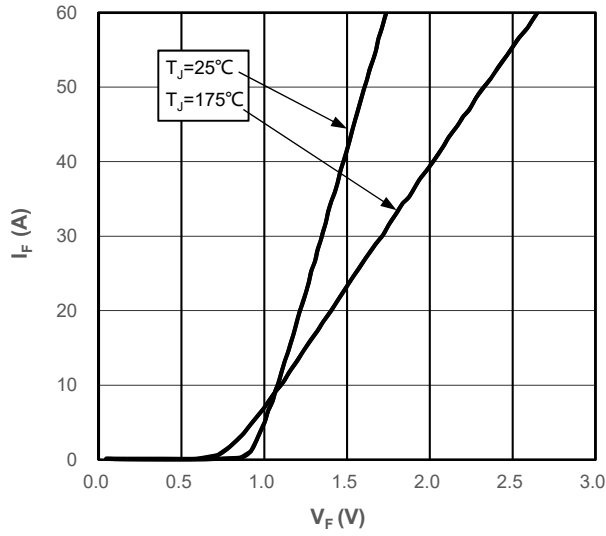

Figure2. Reverse Characteristics

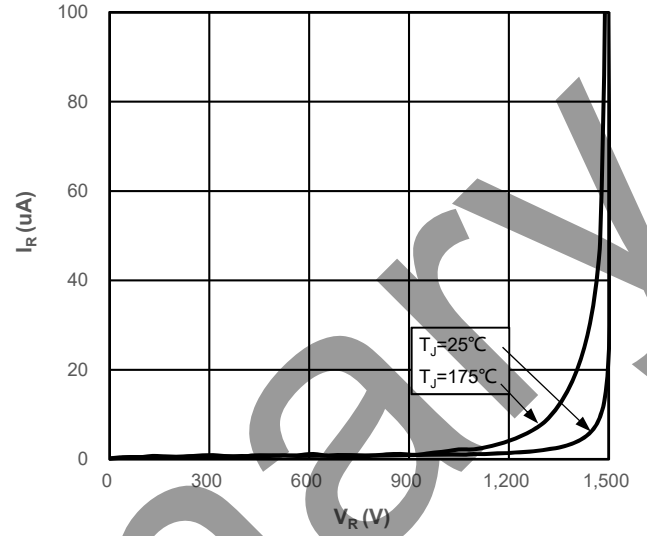

Figure3. Current Derating

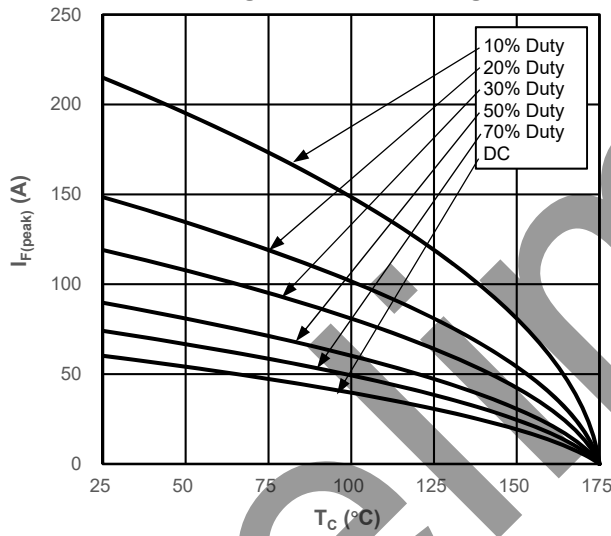

Fig4. Power Derating

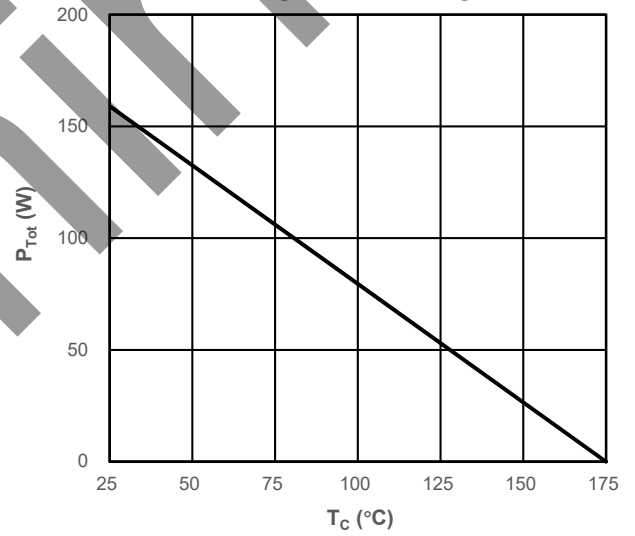

Fig5. Recovery Charge vs. Reverse Voltage

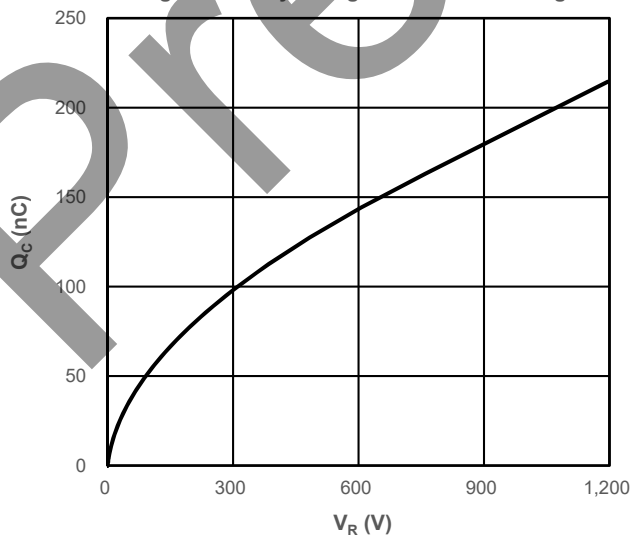
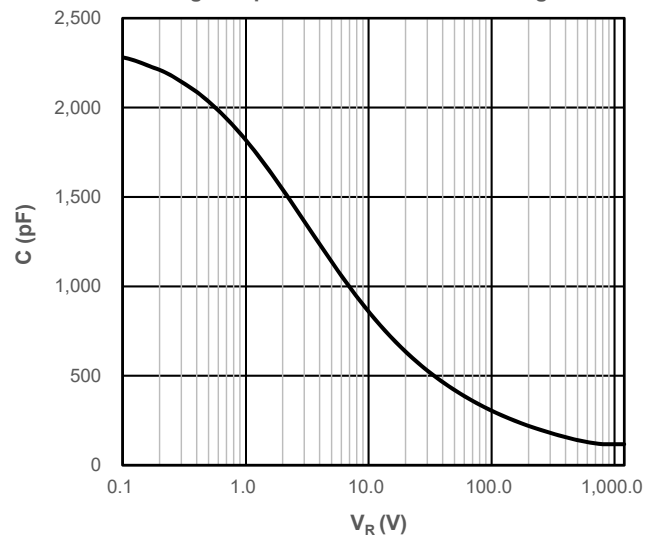
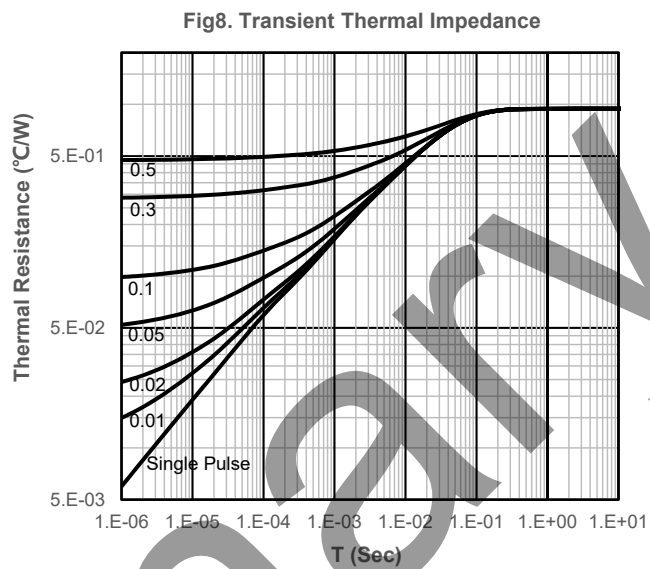
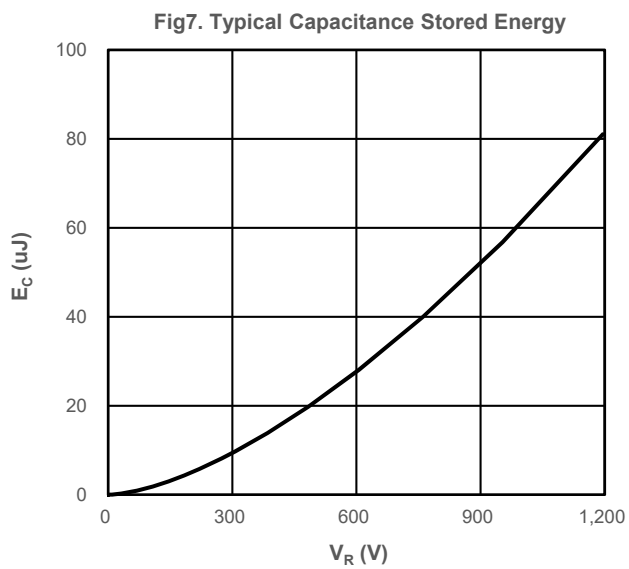

Fig6. Capacitance vs. Reverse Voltage



Curve Characteristics



Preliminary

## Ordering Information

Device	Packing
Part Number-BP	Bulk: 25pcs/Box ; 125pcs/Ctn

**\*\*\*IMPORTANT NOTICE\*\*\***

*Micro Commercial Components Corp.* reserves the right to make changes without further notice to any product herein to make corrections, modifications, enhancements, improvements, or other changes. *Micro Commercial Components Corp.* does not assume any liability arising out of the application or use of any product described herein; neither does it convey any license under its patent rights, nor the rights of others. The user of products in such applications shall assume all risks of such use and will agree to hold *Micro Commercial Components Corp.* and all the companies whose products are represented on our website, harmless against all damages. *Micro Commercial Components Corp.* products are sold subject to the general terms and conditions of commercial sale, as published at <https://www.mccsemi.com/Home/TermsAndConditions>.

**\*\*\*LIFE SUPPORT\*\*\***

MCC's products are not authorized for use as critical components in life support devices or systems without the express written approval of Micro Commercial Components Corporation.

**\*\*\*CUSTOMER AWARENESS\*\*\***

Counterfeiting of semiconductor parts is a growing problem in the industry. Micro Commercial Components (MCC) is taking strong measures to protect ourselves and our customers from the proliferation of counterfeit parts. MCC strongly encourages customers to purchase MCC parts either directly from MCC or from Authorized MCC Distributors who are listed by country on our web page cited below. Products customers buy either from MCC directly or from Authorized MCC Distributors are genuine parts, have full traceability, meet MCC's quality standards for handling and storage. **MCC will not provide any warranty coverage or other assistance for parts bought from Unauthorized Sources.** MCC is committed to combat this global problem and encourage our customers to do their part in stopping this practice by buying direct or from authorized distributors.