



Micro Commercial Components



Micro Commercial Components
20736 Marilla Street Chatsworth
CA 91311
Phone: (818) 701-4933
Fax: (818) 701-4939

G2SB20 THRU G2SB80

2 Amp Glass Passivated Single-Phase Rectifiers 200 to 800 Volts

Features

- High case dielectric strength and High surge current capability
- Glass passivated chip junction
- Lead Free Finish/RoHS(NOTE 1)Compliant ("P" Suffix designates RoHS Compliant. See ordering information)
- Case Material: Molded Plastic. UL Flammability Classification Rating 94V-0 and MSL Rating 1
- Marking : type number

Maximum Ratings

- Operating Temperature: -55°C to +150°C
- Storage Temperature: -55°C to +150°C

MCC Part Number	Maximum Recurrent Peak Reverse Voltage	Maximum RMS Voltage	Maximum DC Blocking Voltage
G2SB20	200V	140V	200V
G2SB60	600V	420V	600V
G2SB80	800V	560V	800V

Electrical Characteristics @ 25°C Unless Otherwise Specified

Maximum Average Forward Current	$I_{F(AV)}$	2 A	$T_A = 25^\circ\text{C}$
Peak Forward Surge Current	I_{FSM}	60A	8.3ms, half sine
Rating for fusing	I^2t	15A ² sec	t<8.3ms
Maximum Instantaneous Forward Voltage	V_F	1.1V	$I_{FM} = 1A;$ $T_A = 25^\circ\text{C}$
Maximum DC Reverse Current At Rated DC Blocking Voltage	I_R	5.0uA 300uA	$T_A = 25^\circ\text{C}$ $T_A = 125^\circ\text{C}$
Typical thermal resistance per leg	$R\theta_{JA}$ $R\theta_{JL}$	40°C/W 12°C/W	

Notes: 1. High Temperature Solder Exemption Applied, see EU Directive Annex Notes 7.

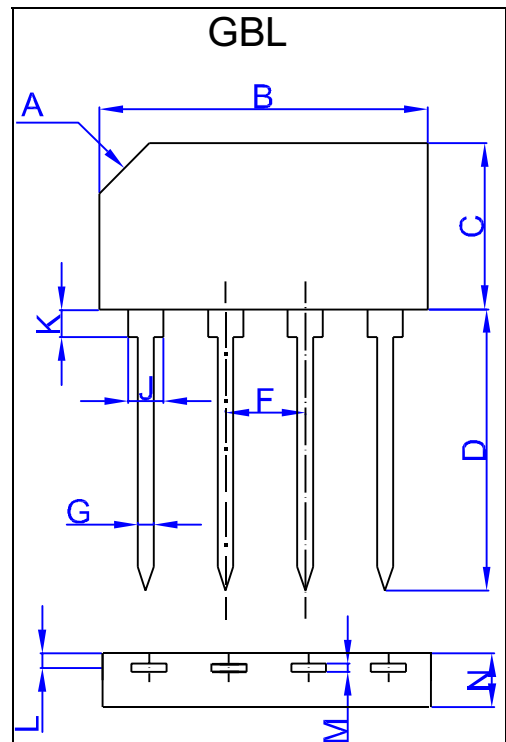

DIM	DIMENSIONS				NOTE
	INCHES		MM		
	MIN	MAX	MIN	MAX	
A	0.125 X 0.125		3.17 X 3.17		X 45°
B	.768	.823	19.5	20.9	
C	.411	.453	10.4	11.5	
D	.682	.740	17.3	18.8	
F	.189	.209	4.80	5.30	
G	.035	.050	0.90	1.27	
J	.063	.098	1.60	2.50	
K	.060	.106	1.05	2.70	
L	.030	.031	0.76	1.20	
M	.016	.026	0.40	0.66	
N	.128	.146	3.25	3.70	

G2SB20 thru G2SB80

Fig. 1 - Derating Curve Output Rectified Current

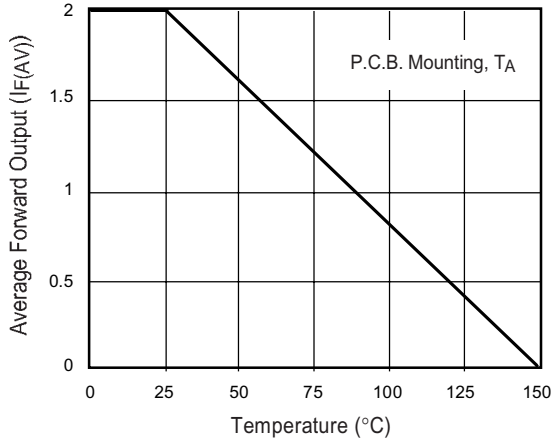

Fig. 2 - Maximum Non-Repetitive Peak Forward Surge Current Per Leg

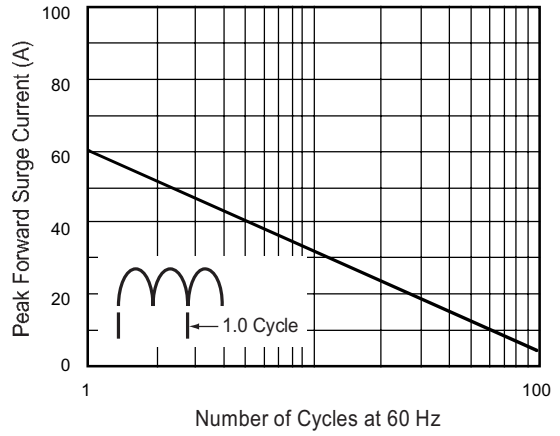

Fig. 3 - Typical Instantaneous Forward Characteristics

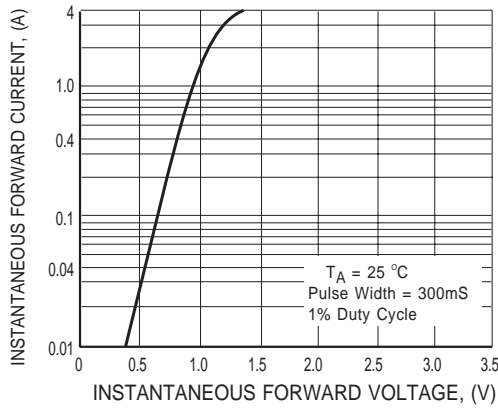
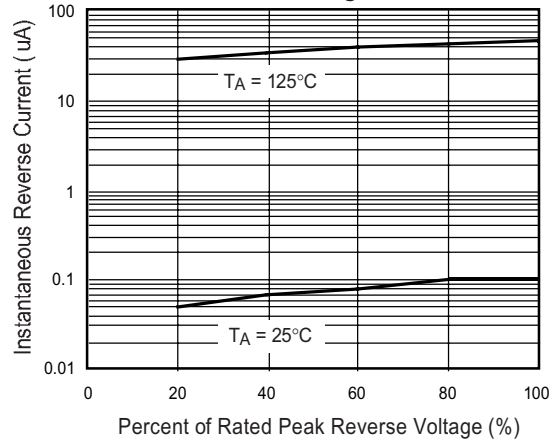

Fig. 4 - Typical Reverse Characteristics Per Leg





Micro Commercial Components

Ordering Information

Device	Packing
(Part Number)-BP	Bulk: 1.35Kpcs/Box, 2.7Kpcs/Ctn

IMPORTANT NOTICE

Micro Commercial Components Corp. reserves the right to make changes without further notice to any product herein to make corrections, modifications, enhancements, improvements, or other changes. **Micro Commercial Components Corp.** does not assume any liability arising out of the application or use of any product described herein; neither does it convey any license under its patent rights, nor the rights of others. The user of products in such applications shall assume all risks of such use and will agree to hold **Micro Commercial Components Corp.** and all the companies whose products are represented on our website, harmless against all damages.

LIFE SUPPORT

MCC's products are not authorized for use as critical components in life support devices or systems without the express written approval of Micro Commercial Components Corporation.

CUSTOMER AWARENESS

Counterfeiting of semiconductor parts is a growing problem in the industry. Micro Commercial Components (MCC) is taking strong measures to protect ourselves and our customers from the proliferation of counterfeit parts. MCC strongly encourages customers to purchase MCC parts either directly from MCC or from Authorized MCC Distributors who are listed by country on our web page cited below. Products customers buy either from MCC directly or from Authorized MCC Distributors are genuine parts, have full traceability, meet MCC's quality standards for handling and storage. **MCC will not provide any warranty coverage or other assistance for parts bought from Unauthorized Sources.** MCC is committed to combat this global problem and encourage our customers to do their part in stopping this practice by buying direct or from authorized distributors.

www.mccsemi.com